

INSTALLING THE DRIVER

Overview: Some computers cannot connect to the bioprinters without the required driver. To enable the connection, follow the instructions below to install the driver.

Materials:

- Bioprinter and USB cable
- Computer
- Driver file

Protocol

1. Connect the bioprinter to the computer with the USB cable.
2. Turn on the bioprinter.
3. Go to "Devices" in windows "Settings"

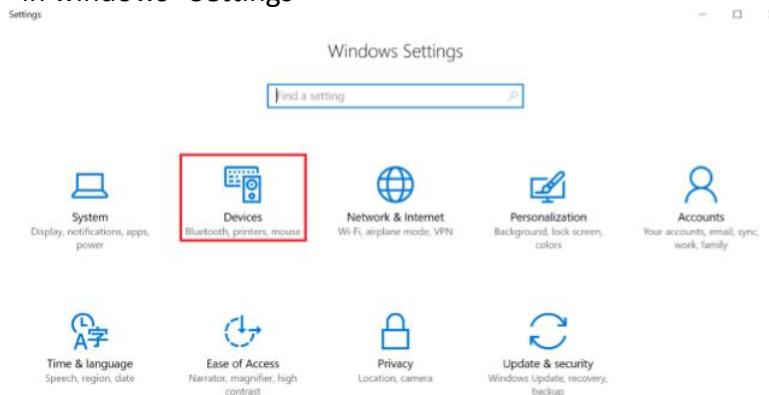

4. Select "Devices and Printers"

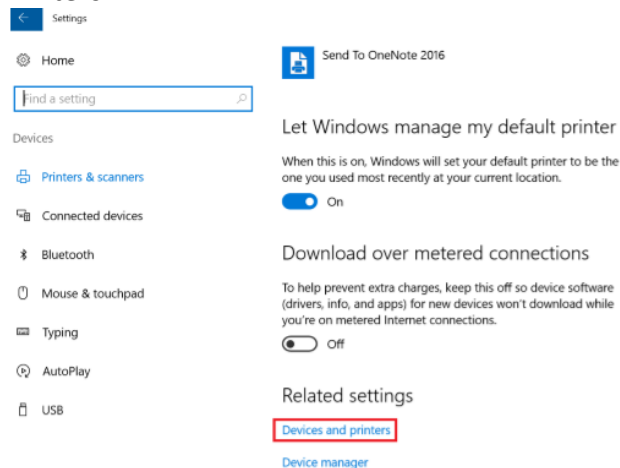

5. Double click on “3D Printer powered by RAMBo”. NOTE: it might not be shown under that name.

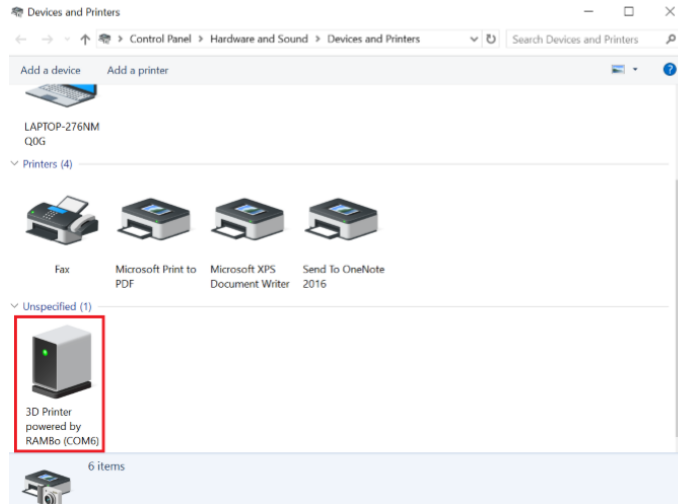

6. On the “Hardware” tab, press “Properties”

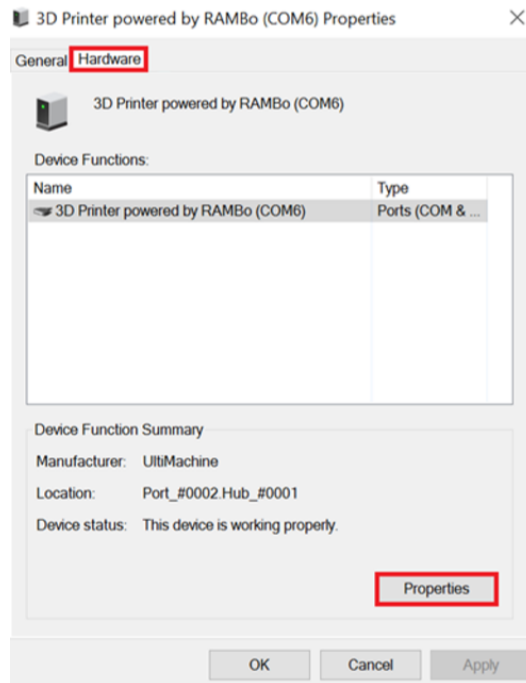

7. Press “Change Settings”

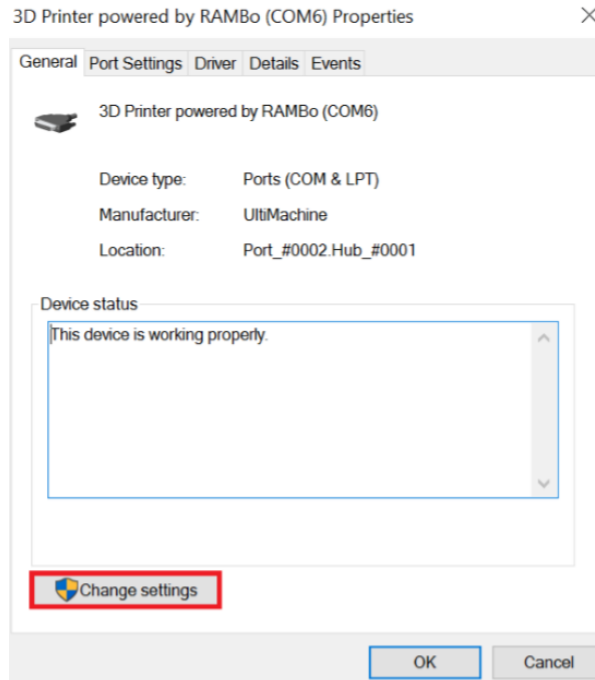

8. On the “Driver” tab press “Update driver”

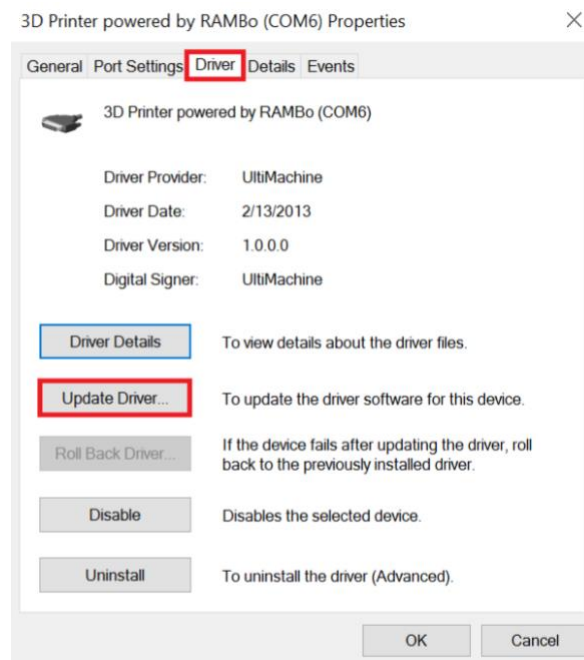

9. Select “Browse my computer for driver software”

Select "Browse my computer for driver software"

← Update Driver Software - 3D Printer powered by RAMBo (COM6)

How do you want to search for driver software?

→ Search automatically for updated driver software

Windows will search your computer and the Internet for the latest driver software for your device, unless you've disabled this feature in your device installation settings.

→ Browse my computer for driver software

Locate and install driver software manually.

10. Download the RAMBo_USBdriver and save it in a know location. Often, this driver is included on the SD card provided to you with your bioprinter. Software->Cellink Host.

11. Browse to where it is saved and select the "RAMBo_USBdriver" folder. Then press "Next"

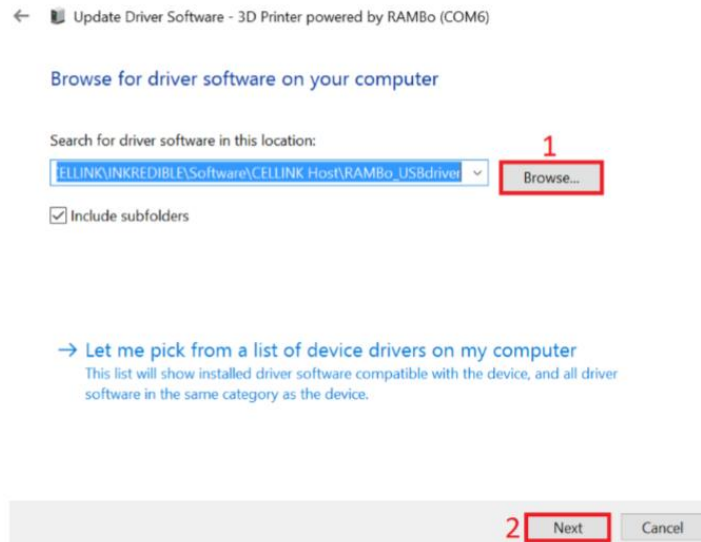

Once the driver is updated, your computer is ready to control your bioprinter.